

DCP SERIES

Padlockable Cam Lock



General Specifications

DCP Series

Function: Cam lock for use with padlock as locking device. Functions on doors or drawers. Ideal for locker applications.

Body: Zinc die cast

Through-hole: 0.4"

Maximum material thickness: 1-1/8"

Barrel diameter: 3/4"

Across flats: 5/8"

Finish: US26 (polished chrome), US3 (polished brass), US19 (flat black)

Packaged: Packed 10 per box

Padlock Specifications

The DCP works with most industry standard padlocks with a shackle diameter of 3/8" (10mm) or less.

Olympus Padlocks

Mountain Brand: Blister packed brass padlocks

Olympus Brand: Box packed brass padlocks

Rekeyable: Schlage composite or Weiser keyway brass padlocks

IC Core: Brass padlocks for Corbin/Ruswin interchangeable cores (sold less core)



The DCP accepts padlocks with a shackle diameter of 3/8" (10mm) or less

Includes

DCNP-500-ARP anti-rotation plate

DCP-SC short straight cam, 5/8"

DCP-LC long straight cam, 1-1/4"

Spacer ring

Typical Door Configuration

Locked position

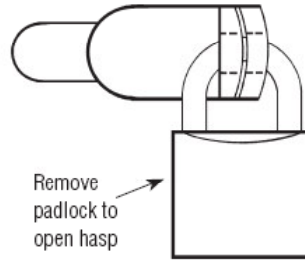

Remove padlock to open hasp

Unlocked position

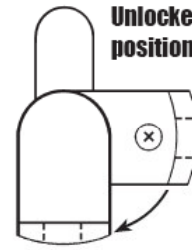

Front arm of hasp will swing down lifting cam

Available Cams:

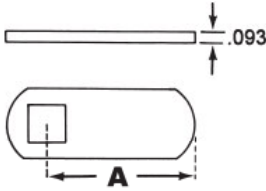

Straight Cams:

Part No.	Dim. A
DCP-SC**	5/8"
DCP-LC**	1-1/4"
DCP-LC-112	1-1/2"
DCP-LC-134	1-3/4"
DCP-LC-225	2-1/4"
DCP-LC-250	2-1/2"

**Ships standard with each lock

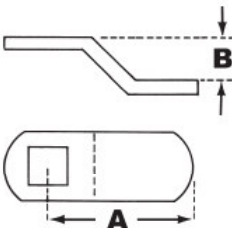

Offset Cams:

Part No.	Dim. A	Dim. B
DCP-1-14	1"	1/4"
DCP-LBC	1-1/4"	1/4"
DCP-118-18	1-1/8"	1/8"
DCP-LBC-138	1-3/8"	3/8"
DCP-LBC-178	1-7/8"	1/2"
DCP-112-14	1-1/2"	1/4"

DCP Dimensions:

